



# MOMOYAMA GAKUIN UNIVERSITY



**INTERNATIONAL  
EXCHANGE PROGRAM  
FOR 2025-26**



# CONTENTS

<b><u>Introduction</u></b>	<b>p.2</b>
<b><u>Exploring Osaka</u></b>	<b>p.3</b>
<b><u>Facilities and Campus Map</u></b>	<b>p.4</b>
<b><u>Academic Calendar</u></b>	<b>p.5</b>
<b><u>Academic Content</u></b>	<b>p.6 - 7</b>
<b><u>International Center &amp; St. John Hall</u></b>	<b>p.8</b>
<ul style="list-style-type: none"><li>- International Center</li><li>- Resident Assistants</li><li>- Buddy</li></ul>	
<b><u>Dormitory</u></b>	<b>p.9</b>
<ul style="list-style-type: none"><li>- Facility</li><li>- Rent</li><li>- Internet</li><li>- Term of Tenancy</li><li>- Room Layout</li></ul>	
<b><u>Scholarship Other financial information</u></b>	<b>p.10</b>
<ul style="list-style-type: none"><li>- Scholarship</li><li>- Other expenses</li></ul>	
<b><u>Other</u></b>	<b>p.11 - 13</b>
<ul style="list-style-type: none"><li>- Field trip</li><li>- Navigating the Nuclear Age: Osaka-Nagasaki Student Research on Contemporary Challenges</li><li>- Instagram</li></ul>	





# MOMOYAMA GAKUIN UNIVERSITY



## INTRODUCTION

Welcome to you from all of us at Momoyama Gakuin University. We hope that you will learn more about Japanese language, culture, and people during your exchange program. We would like to support you so that your days in Japan will be fruitful as well as memorable. Students, faculty members, and staff members of the university are eagerly waiting for you to join us. Before you begin your new life in Japan, please read this brochure thoroughly and carefully. You will probably have general ideas on what to expect in and around Momoyama Gakuin University. We will explain more details to you during the orientation week.

## LOCATION

Momoyama Gakuin University is in Izumi City located in the south part of Osaka, an area with a good-old Japan atmosphere. Due to the numerous shrines, temples, and parks within the city, you will be able to surround yourself in a natural environment. Izumi City is about 30 minutes from Osaka downtown and Kansai International Airport. It's convenient location provides easy access to Kansai's famous locations such as Namba, Umeda, Kyoto and Nara.





# EXPLORING OSAKA

Osaka is the second biggest city in Japan and located in Kansai region which is in the west part of Japan. The population is approximately 8,800,000. Because Osaka is known as a commercial city, there is so much entertainment that attracts a lot of people.



Momoyama is located in a quiet suburban area surrounded by quiet environment. It is the best place to focus on your studies and research.



# Facilities and Campus Map



## Classroom Buildings (No.1-3)

Classrooms, the Office for Audio-visual Materials and the Hi-Definition Theater

## St. Andrew Hall (No.4) (Library)

Library and Faculty member's office

## St. Thomas Hall (No.5)

Information Center and Snack shop

## St. Peter Hall (No.6)

The Educational Affairs Section, the Financial Affairs Section, the Student Affairs Section and the Health Care Room

## St. Barnabas Hall (No.7)

A canteen and the dining halls

## Canterbury Hall (No.8)

The Auditorium and "Family Mart" convenience store

## St. Margaret Hall (No.9)

A canteen and the dining hall

## St. John Hall (No.10)

The International Center, St. John Hall (serving as a community center for students), and a coffee shop

## Gymnasium (No.11)

An indoor swimming pool and a training room  
※You must attend our gym orientation session before using it.

## St. Saviour Chapel (No.12)

St. Saviour Chapel is the symbol of Momoyama Gakuin University.

# ACADEMIC CALENDAR (TBD)

- Spring semester
- Fall semester

- Classes begin
- The Anniversary of The Founding
- Field trip

April

4

October

10



May

5

November

11

- Field trip
- University Festival



June

6

December

12

- Christmas Carol Service
- The last day of classes
- Winter break begins

- The last day of classes
- Final examinations begin

July

7

January

1

- Winter break ends
- Classes resume
- The last day of classes
- Final examinations begin

- Summer break begins
- Make-up class period

August

8

February

2

- Spring break begins
- Make-up class period

- Summer break ends
- Class begins

September

9

March

3



# ACADEMIC CONTENTS

## ■ Compulsory Japanese courses 2 credits (90 mins\* 1 or 2 classes per week)

\*Required classes are determined by the results of the placement test.

Subjects	Learning contents
Japanese I (Level A)	Beginner
Japanese I (Level B)	First half of beginner level
Japanese I (Level C)	Second half of beginner to early intermediate
Japanese I (Level D)	Beginner-intermediate level (Conversation-oriented)
Japanese I • III (Spring semester) Japanese II • IV (Fall semester)	Upper intermediate level (Writing and reading comprehension)
Advanced Japanese	Advanced (Comprehensive exercises)

## ■ Elective Japanese courses

Students can choose classes that interest them and study content related to the Japanese language and Japan.

\*However, students must be at least level D or above to take these courses

Subjects	Learning contents
N2 Course (Grammar)	Grammar at JLPT N2 level
N2 Course (Listening and Reading Comprehension)	Reading and listening comprehension at JLPT N2 level
N1 Course (Grammar)	Grammar at JLPT N1 level
N1 Course (Listening and Reading Comprehension)	Reading and listening comprehension at JLPT N1 level
Introduction to Japanese Studies (Basic)	Basic knowledge of everyday life, including Japanese geography and annual events. *Can be taken at level C or above.
Introduction to Japanese Studies (Applied/Business Japanese)	Learn the basics of business etiquette and business conversation (keigo).
Introduction to Japanese Studies A (Spring semester)  Introduction to Japanese Studies B (Fall semester)	Discussions and presentations on various topics in Japanese society.



## Regular Courses

Basically, exchange students can take classes in any department regardless of the department they belong to at Momoyama. In addition, some classes are offered in English.

[Reference]

Lecture Schedules for 2025	
*All courses below are offered in English.	
Spring Semester	
Topics in Economics – Economic Affairs in Japan and Asia (lecture in English)	
Topics in Economics-problems in labour economics	
Special Topics in International Exchange-Introduction to Contemporary Japanese	
Global Experience Study and Fieldwork-Exploring the human language system with overseas students	
Seminar I	
Seminar II	
Intercultural Understanding Seminar-History of American Literature A	
Intercultural Understanding Seminar-History of American Literature B	
Special Topics in International Exchange-Japan's National Security	
Lecture on Special Topic-Miyazaki Hayao's World of Anime	
PBL English-Collaborative Skills and Problem-Solving A	
Special Topics in International Exchange-Marketing Management	
Special Topics in International Exchange-Introduction to the Japanese Economy	
Special Topics in International Exchange-Contemporary Global Issues	
Special Topics in International Exchange-The Psychology of Diversity	
Fall Semester	
Topics in Economics-Statistical Analysis of The Present-Day Japanese Economy	
Special Topics in International Exchange-Education in Japan	
Special Topic in Liberal Arts -Doing Business with the Japanese Practices for International Students	
*This subject may not be available due to limited numbers of students.	
Seminar I	
Seminar II	
Japanese Studies-Ecology through Animations	
Global Experience Study and Fieldwork-Walking and thinking around shrines and temples in Osaka	
Lecture on Special Topic-Miyazaki Hayao's World of Anime	
PBL English-Collaborative Skills and Problem-Solving B	
Special Topics in International Exchange-Marketing Management	
Special Topics in International Exchange-Introduction to the Japanese Economy	
Special Topics in International Exchange-Contemporary Global Issues	
Cultures and Societies I B *This subject may not be available due to limited numbers of students.	
Discussion and Debate I B *This subject may not be available due to limited numbers of students.	





# International Center and St. John Hall



## Support for International Students

### International Center

The office of International Center is located on the street level of St. John Building. The center provides information and support for all international students. St. John Hall is a community center for faculty members and students. It is a great place to study if you want to make friends with Japanese students.

### Resident Assistants

Resident assistants (RAs) are full-time Momoyama students who assist the international exchange students living away from their home town to lead safe and pleasant dormitory lives.

### Buddy

The International Center will select a buddy for you. (Only for those who applied for the buddy program)  
She or he is a full-time student and will support the daily life of international exchange students who have just come to Japan.

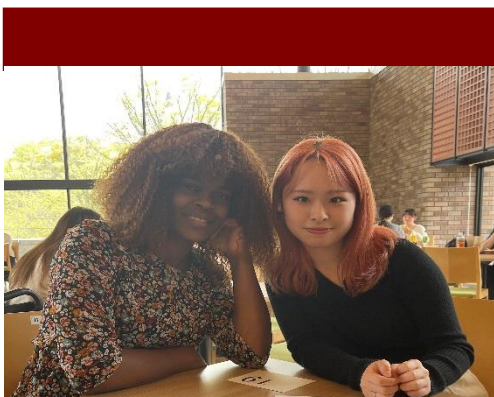



# Dormitory



**Resident assistants** (Momoyama's Japanese students) are living in this Dormitory and they will be glad to give you advice about living in Japan.

## Details

### Furniture

- \* Air conditioner
- \* Refrigerator
- \* Washing machine
- \* Single bed
- \* Bedding sets
- \* Microwave

### Rent

240,000JPY/semester

### Internet

Included

### To Momoyama

Walking distance

### To the nearest station (Izumi Chuo Station)

Walking distance

## Room layout

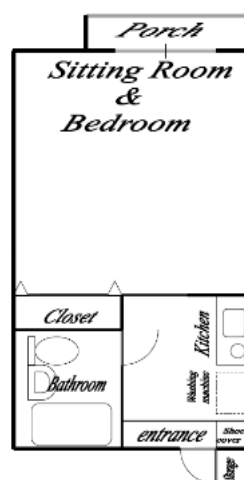

- \*DO NOT make loud noise late at night. In particular, parties are strictly prohibited in the building.
- \*You must pay the ENTIRE AMOUNT of rent for a semester (JPY240,000) at beginning of each semester. Payment is only acceptable in CASH.
- \*All exchange students will live in the International Student Dormitory. No special procedure is required to move in.
- \*Utilities (Gas, Electricity, and Water) are NOT included in the rent, and tenants must pay the bills on their own.
- \*Internet fee is included in your semester fees.
- \*If you arrive in mid-September or mid-March, a resident assistant can pick you up at Kansai International Airport and you can move into your flat on the first day.
- \*The fees and schedule in this brochure are subject to change.





# Scholarships

<b>Agreement-based scholarships</b>	MGU or some of private scholarships are available to <u>those exchange applicants from the institution with which Momoyama Gakuin University has reached a scholarship agreement.</u> For more details, please email us to <a href="mailto:inbound@andrew.ac.jp">inbound@andrew.ac.jp</a> .
<b>Japan Student Services Organization Scholarship (JASSO) scholarship</b>	MGU will announce to the candidate student(s) directly based on availability.
<b>Private/Public scholarship</b>	MGU will announce to the home institutions only when it is available.

## Other expenses

<b>Semester fee</b>	60,000 JPY/semester <b>*Cash payment only</b>
<b>Medical-care insurance</b>	<p>In principle, all exchange students have to join Japanese National Health Insurance after arriving in Japan.</p> <p>With the Japanese National Health Insurance, 70% of medical costs are covered.</p> <p>At the same time, we require all exchange students to purchase Momoyama Inbound insurance (see below), that works alongside the mandatory National Health Insurance to provide 100% coverage*.</p> <p>Please note that <u>without this additional insurance policy, students CANNOT register in any courses.</u></p> <p>■ Momoyama Inbound insurance PREMIUM</p> <p>*The price and coverage are subject to change. (Should be paid in cash)</p> <p>1 semester: Up to JPY 10,000 2 semesters: Up to JPY 15,000</p>
<b>Approximate cost of living per semester</b>	[Utility/Living costs / Personal spending, etc. for a semester] <b>300,000 - 500,000JPY / semester</b> *Living costs vary depending on student lifestyle

# Other

## Field trip

Once a semester, exchange students, RAs (Resident Assistants), and International Center staff participate in a field trip (one-day trip) (free of charge). \*The cost of meals, snacks, souvenirs and other personal cost are at your own expense.

Destination (tentative)

Spring 2025 semester

Universal Studios Japan

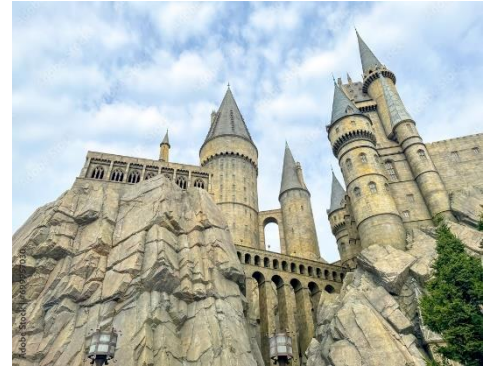



# You can participate in the Navigating the Nuclear Age:

## Osaka-Nagasaki Student Research on Contemporary Challenges

Applicants may participate in the Navigating the Nuclear Age: Osaka-Nagasaki Student Research on Contemporary Challenges program free of charge. **\*Selection is required.**

【Purpose and Contents of Navigating the Nuclear Age: Osaka-Nagasaki Student Research on Contemporary Challenges】

- Pre-lectures and project-based learning during the semester (Scheduled to start in May)
- Three-day field trip during the summer holidays
  - Visiting the Nagasaki Atomic Bomb Museum
  - Participation in an International Peace Event and a Peace Memorial Ceremony
- A project presentation at Nagasaki University [ENGLISH]

The Nagasaki Atomic Bomb Museum, which you will visit during your fieldwork, is a facility that conveys the horror of war and prayers for peace to future generations.

We invite you to participate in the project in Nagasaki, a city with a multicultural past, with a history of trade with Europe and Christianity through Dejima.

\*For more information, please email <inbound@andrew.ac.jp>.





# Instagram

This is the Instagram of Momoyama Gakuin University International Center.  
We introduce the multicultural ambience of Momoyama Gakuin University.  
Please follow us!







# Momoyama Gakuin University (St. Andrew's University)

1-1 Manabino, Izumi, Osaka 594-1198, Japan

## The International Center

Office Hours: 9:10 – 16:40 (Mon - Fri)

TEL: +81-(0)725-92-7531

E-mail: [inbound@andrew.ac.jp](mailto:inbound@andrew.ac.jp)

URL: <https://www.andrew.ac.jp/english/>